

TECHNICAL DATASHEET

DAISY-3 3xE14 CHROME

01-07-2020

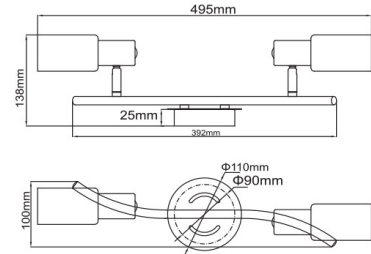

VT/DAISY-3/3xE14/CHR/220V/SPOT LAMP

NOTES

General Informations

Stock Code	2100390
HSC/GTIP Code	9405.10.98.50.00
EAN-13 (Inbox Barcode)	8680168580327
ITF-14 (Outbox Barcode)	28680168580321

Mechanical Parameters

IP Protection Class	IP20
Body Material	Metal Sheet & Glass
Body Colour	Chrome
Diffuser Material	Glass
Product Height	653 millimeter
Product Width	138 millimeter
Ambient Temperature (Ta)	-10°C<Ta<45°C

Electrical Characteristics

Current Type	AC
Operation Voltage	220-240 Volt
Operation Frequency	50/60 Hertz
Power	Max 3x40 Watt
Electrical Protection Class	Class I

Logistic Informations

Outbox Length	500 millimeter
Outbox Width	410 millimeter
Outbox Height	600 millimeter
Outbox Volume	0,123 m ³
Outbox Quantity	12 pieces
Unit Net Weight	0,77 kilogram
Outbox Net Weight	9,24 kilogram
Outbox Gross Weight	13,35 kilogram

Lighting Characteristics

Light Beam Angle	120°
------------------	------

IMPORTANT NOTES: VITO reserves the right to change/remove models or specifications partially/completely without any notice. Information, models and photographs of the products in this technical datasheet can not be used, reproduced or published without permission. However, some parts can be quoted by giving reference and/or chapter number belonging to technical datasheet. Most of the items in the datasheet have been designed by our company within indicated technical specifications inside. Our company is not responsible for errors caused by wrong installation and operating against rules according to qualifications specified in the product details. Photographs printed in this datasheet may not reflect the actual color of the product depending on printing conditions. In the same context, typographical errors may possibly be found in the texts.